

Wire Greeting Card Stand Assembly Instructions

Parts List

Please ensure that you have all these parts before assembling the unit.



- 1. Wire Frame x1
- 2. Poles x2
- 3. Bearing x1
- 4. Sign Holder x1



- 5. Metal Ring x1
- 6. Pin x 1
- 7. Metal Base x1



Tap the unit a few times on the floor to ensure the post is inserted snugly into the base.

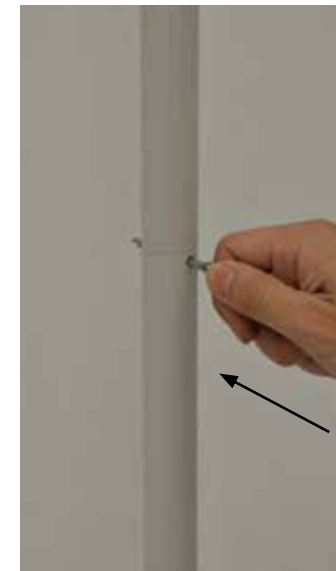

Insert the assembled pole into the base.

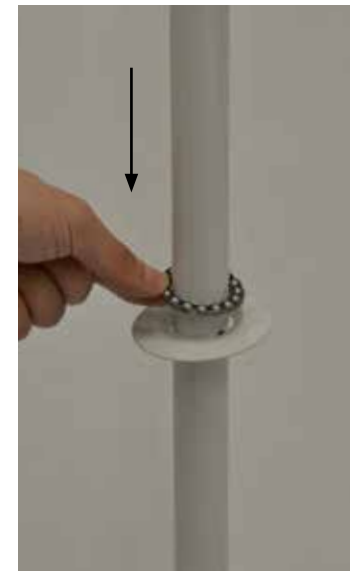

Insert the pin into the hole at the bottom of the pole.

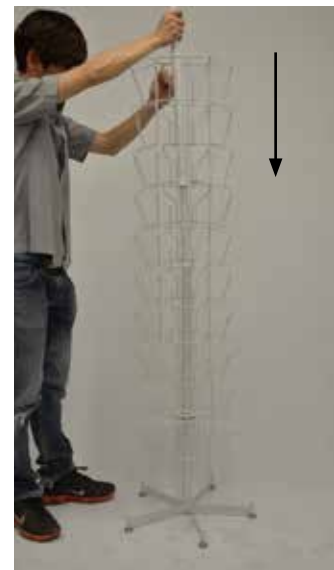

Slide the metal ring over the pole followed by the bearing.

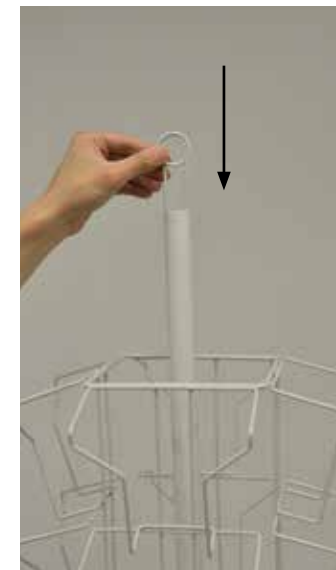

Slide the wire frame over the pole until it rest on the bearing

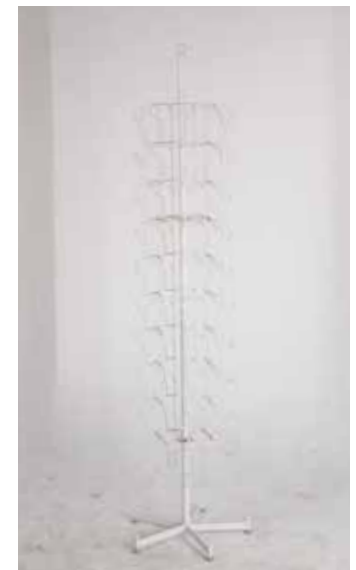

Insert the sign holder into the top of the pole

Your unit is now assembled