

Assembly Instructions

Parts List:

- 1x Double sided Snap Frame
- 2x Protective Lens
- 2x Spring Feet
- 1x Plastic Base
- 2x Bolts



1 Screw the spring feet onto the poster frame



2 Insert the spring legs into the holes in the heavy duty base

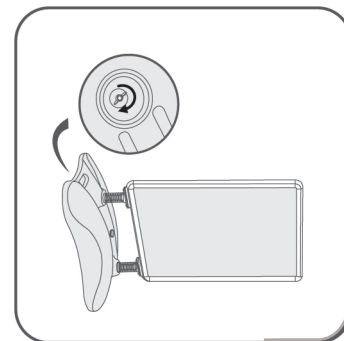

3 Tilt the unit over. Tighten the bolt supplied to fix the frame to the base

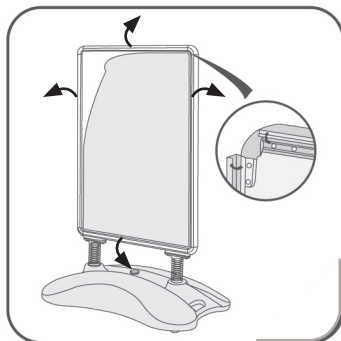

4 Snap open the four sides and remove the plastic protector sheet to insert graphic poster.

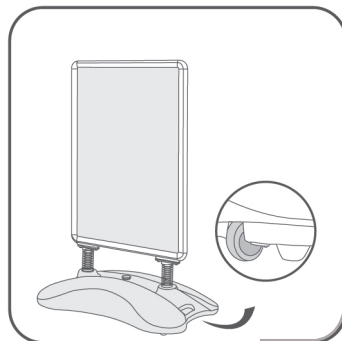

5 The unit can be easily wheeled into position.



6 The base can be filled with water or sand to make it more stable.

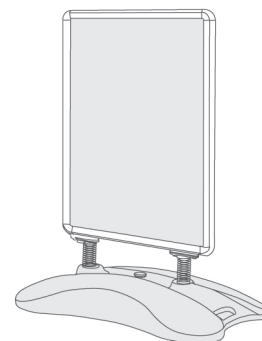

The unit is ready to be used.